

PMS - (New 550Vdc rating; expanded range; new lugs)

Metallized polypropylene film capacitor

MKP - Switching / Snubber - High current



Main applications

Switching capacitor for resonant circuits, industrial and motor speed controls, induction heaters, high frequency and high current applications

Dielectric

Polypropylene

Electrodes

Vacuum deposited metal layers

Coating

Solvent resistant plastic case with resin sealing (UL 94 V-0). Flame retardant execution

Construction

Extended metallized film with internal series connection (refer to general technical information)

Terminals

Tinned copper (brass) lugs (lead-free) for screw fixing (please refer to article table)

Degree of protection

IP00

Installation

Whatever position assuring correct heat dissipation. Arrangement of many components with box walls in contact not admitted; suggested minimum distance between side by side elements $\geq 1/8$ of the box thickness (B size). Box with lugs terminals must be free to correctly dissipate from all the body faces

Reference standard

IEC 61071, IEC 60068, RoHS compliant

Climatic category

40/85/56 (IEC 60068/1), GPD (DIN40040)

Operating temperature range (case)

-40°...+85°C (+100°C observing voltage and current de-rating)

Max. permissible ambient temperature

+70°C, operation at rated power, current, voltage and natural cooling (+85°C observing voltage and current de-rating)

Rated capacitance (Cr)

0,068F to 18,5 μ F. Refer to article table

Capacitance tolerance (at 1kHz)

$\pm 10\%$ (code=K), $\pm 5\%$ (code=J). Other tolerances upon request

Capacitance temperature coefficient

Refer to graphs in general technical information

Long term stability (at 1 kHz)

Capacitance variation $\leq \pm 1\%$ after a period of 2 years at standard environmental conditions

Rated voltage (Ur), +85°C

550, 700, 850, 1000, 1200, 1500, 2000, 2500, 3000 Vdc

Temperature de-rated voltage

For operating temperature (case) $> +85^\circ\text{C}$,

Ur must be decreased 1,5% for every °C exceeding +85°C

Urms must be decreased 2,5% for every °C exceeding +85°C

Non recurrent surge voltage (Upk), +85°C

900, 1100, 1300, 1550, 1750, 2200, 2600, 3300, 4000 Vdc

Self inductance

$\leq 1\text{nH/mm}$ of fixing pitch

Maximum pulse rise time

Refer to article table

Maximum peak current (Ipeak)

Refer to article table. Max. non repetitive Ipk = 1,5 x Ipeak

Dissipation factor (DF), max.

Tg $\delta \times 10^{-4}$, measured at 25 $\pm 5^\circ\text{C}$, 1kHz

| Cr $\leq 0,1\mu\text{F}$ | 0,1 μF <Cr $\leq 1\mu\text{F}$ | 1 μF <Cr $\leq 6,8\mu\text{F}$ | 6,8 μF <Cr $\leq 9\mu\text{F}$ | Cr $> 9\mu\text{F}$ |
|--------------------------|---|---|---|---------------------|
| 6 | 5 | 6 | 7 | 10 |

Insulation resistance (IR)

$\geq 30000\text{s}$ but need not exceed 30G Ω (typical value), when measured between terminals, at 25 $\pm 5^\circ\text{C}$, after 1 minute of electrification at 100Vdc

Test voltage between terminals (Ut)

1,6xUr (DC) applied for 10s / 2xUr (DC) applied for 2s, at 25 $\pm 5^\circ\text{C}$

Test voltage between terminals and case (Utc)

3kV 50+60Hz applied for 60s at 25 $\pm 5^\circ\text{C}$

Damp heat test (steady state)

Test conditions:

Temperature= +40 $\pm 2^\circ\text{C}$

Relative humidity=93 $\pm 2\%$

Test duration= 56 days

Performance:

Capacitance change $\leq \pm 2\%$

DF change ≤ 0.0010 at 1kHz

IR $\geq 50\%$ of initial limit value

Typical capacitance change versus operating time

-3% after 30'000 hours at Urms or after 100'000 hours at Ur

Life expectancy

$\geq 100'000$ hours (Ur); 30'000 hours (Urms)

Failure quota

300/10⁹ component hours

Warning: this specification must be completed with the data given in the "General technical information" chapter

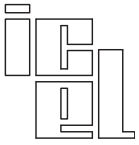

PMS - (New 550Vdc rating; expanded range; new lugs)

Metallized polypropylene film capacitor

MKP - Switching / Snubber - High current



Dimensions in mm (drawings not in scale)

Style **SP-SPM8 / SR-SRM8**

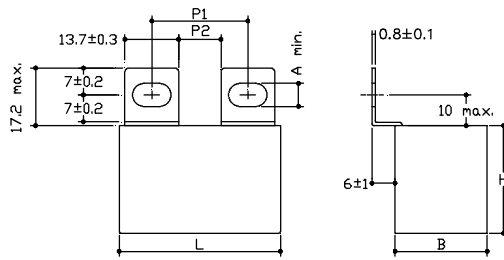

Style **VP-VPM8 / VR-VRM8**

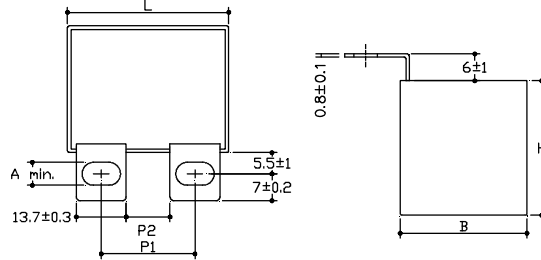

Style **FP-FPM8 / FR-FRM8**

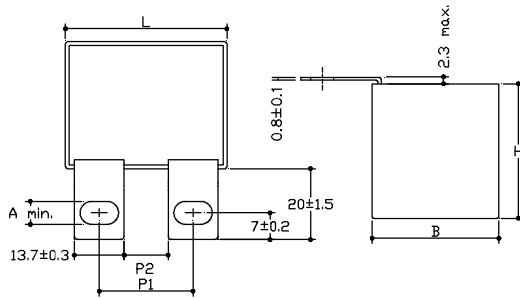

| Fixing pitch and distance between lugs (mm) | | | | |
|---|---------|-----------|-----------|--------|
| Lugs style | L | P1 | | P2 |
| SP-SPM8 | 42+42,5 | 23+28(M6) | 25+26(M8) | 11min. |
| VP-VPM8 | 57,5 | 37+42(M6) | 39+40(M8) | 24min. |
| FP-FPM8 | | | | |
| SR-SRM8 | 42+42,5 | 20+25(M6) | 22+23(M8) | 8min. |
| VR-VRM8 | 57,5 | 34+39(M6) | 36+37(M8) | 21min. |
| FR-FRM8 | | | | |

| Fixing slot size (mm)** | |
|------------------------------------|----------|
| SP, VP, FP, SR, VR, FR | A= 6min. |
| SPM8, VPM8, FPM8, SRM8, VRM8, FRM8 | A= 8min. |

**** Standard fixing slots for M6 screws, slots for M8 screws available upon request**

Style **SN-SNM8** (for L=57,5mm only)

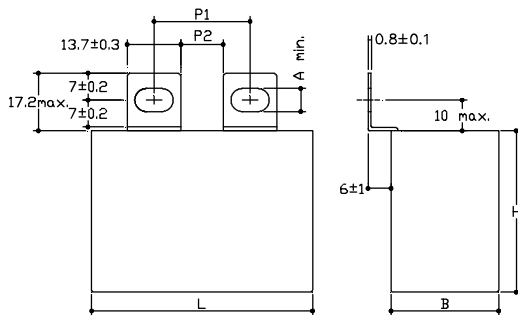

Style **VN-VNM8** (for L=57,5mm only)

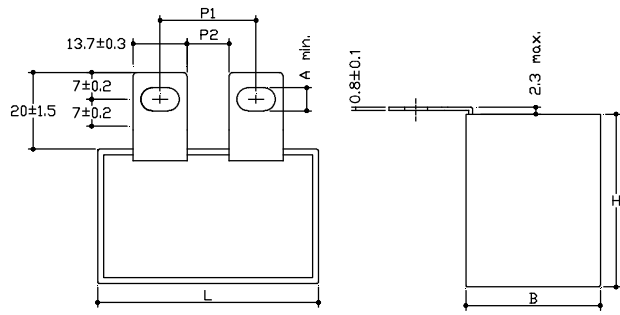

| Fixing pitch and distance between lugs (mm) | | | | |
|---|---------|---------------|-----------|--------|
| Lugs style | L | P1 | | P2 |
| SN-SNM8 | 42+42,5 | Not available | | |
| VN-VNM8 | 57,5 | 23+28(M6) | 25+26(M8) | 11min. |

| Fixing slot size (mm)** | |
|-------------------------|----------|
| SN, VN | A= 6min. |
| SNM8, VNM8 | A= 8min. |

**** Standard fixing slots for M6 screws, slots for M8 screws available upon request**

Style **AP**

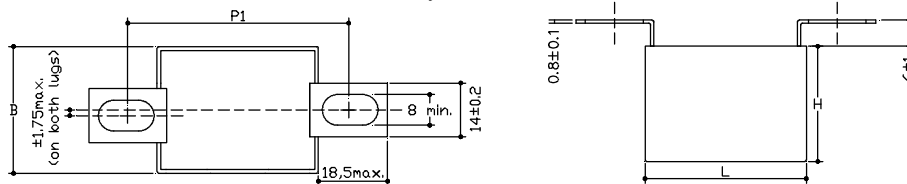

| Fixing pitch and distance between lugs (mm) | | | |
|---|---------|--------------|----|
| Lugs style | L | P1 | P2 |
| AP | 42+42,5 | 53,5+63 (M8) | - |
| | 57,5 | 68,5+77 (M8) | - |

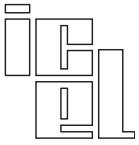

PMS - (New 550Vdc rating; expanded range; new lugs)
Metallized polypropylene film capacitor
MKP - Switching / Snubber - High current



Dimensions in mm (drawings not in scale)

Style **BP** (Not available for L=57,5mm)

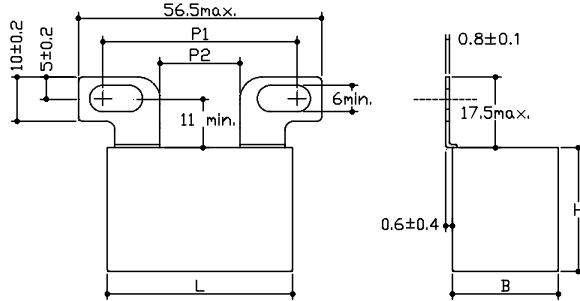

| Fixing pitch and distance between lugs (mm) | | | |
|---|---------|---------------|--------|
| Lugs style | L | P1 | P2 |
| BP | 42÷42,5 | 32÷45 (M6) | 17min. |
| | 57,5 | Not available | |

Style **SL** (M8 slots only)

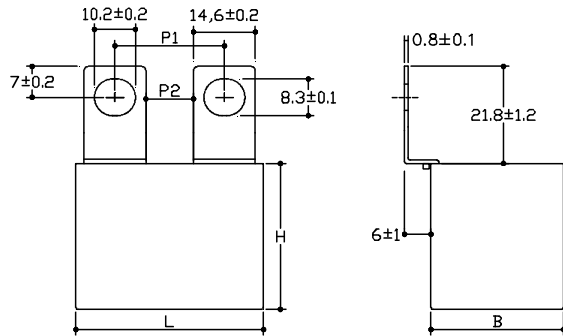

| Fixing pitch and distance between lugs (mm) | | | |
|---|---------|------------|--------|
| Lugs style | L | P1 | P2 |
| SL | 42÷42,5 | 22÷24 (M8) | 8min. |
| | 57,5 | 36÷38 (M8) | 21min. |

Style **BN** (M6 slots only; not available for L=57,5mm and for L=42÷42,5mm having B>22mm)

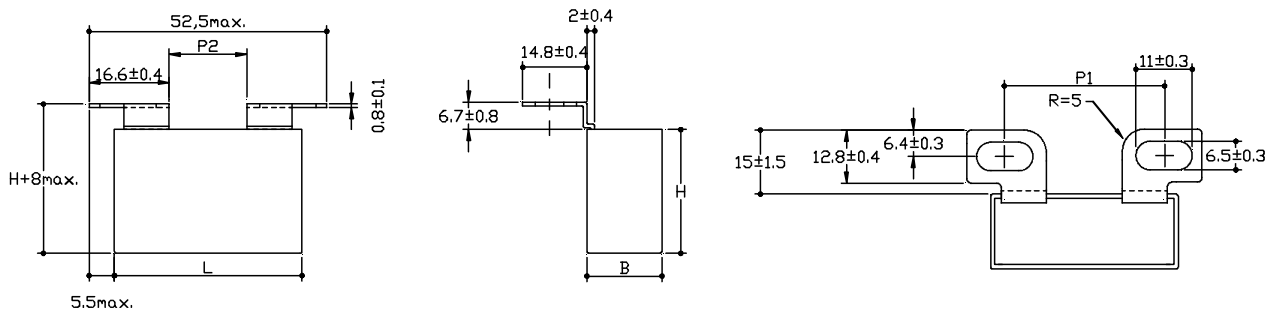

| Fixing pitch and distance between lugs (mm) | | | |
|---|---------|------------------------|--------|
| Lugs style | L | P1 | P2 |
| BN | 42÷42,5 | 30÷37 (M6) | 15min. |
| | | Not available for B>22 | |
| | 57,5 | Not available | |

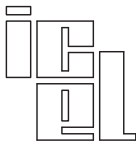

PMS - (New 550Vdc rating; expanded range; new lugs)

Metallized polypropylene film capacitor

MKP - Switching / Snubber - High current



PMS article table (different values available upon request) - (^)= NOT FOR NEW DESIGN: replaced with 30x45x42.5mm box

| Ur Vdc | Urms Vac ⁽⁴⁾ | UpK Vdc | Cap. µF | Dimension in mm | | | du/dt V/µs | Ipeak A | Irms ⁽²⁾ A | ESR ⁽³⁾ mΩ | ICEL Code ⁽¹⁾ |
|-----------|----------------------------|------------|------------|-----------------|------|------|---------------|------------|--------------------------|--------------------------|--------------------------|
| | | | | B | H | L | | | | | |
| 550 | 340 | 900 | 2 | 17 | 28 | 42,5 | 110 | 220 | 13 | 4,3 | PMS1554200*## |
| 550 | 340 | 900 | 2,2 | 17 | 28 | 42,5 | 110 | 242 | 13,5 | 4,1 | PMS1554220*## |
| 550 | 340 | 900 | 2,5 | 17 | 32 | 42 | 110 | 275 | 15 | 3,8 | PMS1554250*##A |
| 550 | 340 | 900 | 2,5 | 24,5 | 27,5 | 42,5 | 110 | 275 | 15 | 3,8 | PMS1554250*## |
| 550 | 340 | 900 | 3 | 22 | 30 | 42,5 | 110 | 330 | 16,5 | 3,2 | PMS1554300*##A |
| 550 | 340 | 900 | 3 | 24,5 | 27,5 | 42,5 | 110 | 330 | 16,5 | 3,2 | PMS1554300*## |
| 550 | 340 | 900 | 3,3 | 22 | 30 | 42,5 | 110 | 363 | 17,5 | 3,1 | PMS1554330*## |
| 550 | 340 | 900 | 3,9 | 22 | 33,5 | 42,5 | 110 | 429 | 19 | 2,7 | PMS1554390*## |
| 550 | 340 | 900 | 4,7 | 28 | 37 | 42,5 | 110 | 517 | 22,5 | 2,3 | PMS1554470*## |
| 550 | 340 | 900 | 5 | 28 | 37 | 42,5 | 110 | 550 | 23 | 2,3 | PMS1554500*## |
| 550 | 340 | 900 | 5,6 | 28 | 37 | 42,5 | 110 | 610 | 24,5 | 2,1 | PMS1554560*##A |
| 550 | 340 | 900 | 5,6 | 33,5 | 35,5 | 42,5 | 110 | 610 | 24,5 | 2,1 | PMS1554560*## |
| 550 | 340 | 900 | 6,8 | 30 | 45 | 42,5 | 110 | 748 | 29,5 | 1,9 | PMS1554680*## |
| 550 | 340 | 900 | 7,5 | 33 | 45 | 42,5 | 110 | 825 | 31 | 1,8 | PMS1554750*## |
| 550 | 340 | 900 | 10 | 30 | 45 | 57,5 | 72 | 720 | 29 | 2,1 | PMS1555100*## |
| 550 | 340 | 900 | 13 | 35 | 50 | 57,5 | 72 | 936 | 33 | 1,9 | PMS1555130*## |
| 550 | 340 | 900 | 15 | 38 | 57,5 | 57,5 | 72 | 1080 | 34,5 | 1,7 | PMS1555150*## |
| 550 | 340 | 900 | 18,5 | 38 | 57,5 | 57,5 | 72 | 1332 | 38 | 1,6 | PMS1555180*## |
| 700 | 420 | 1100 | 1,5 | 17 | 28 | 42,5 | 150 | 225 | 15 | 3,5 | PMS1704150*##B |
| 700 | 420 | 1100 | 1,5 | 24,5 | 27,5 | 42,5 | 150 | 225 | 15,5 | 3,5 | PMS1704150*## |
| 700 | 420 | 1100 | 2 | 24,5 | 27,5 | 42,5 | 150 | 300 | 17,5 | 3,1 | PMS1704200*## |
| 700 | 420 | 1100 | 2 | 22 | 30 | 42,5 | 150 | 300 | 17,5 | 3,1 | PMS1704200*##A |
| 700 | 420 | 1100 | 2,2 | 22 | 33,5 | 42,5 | 150 | 330 | 18 | 3 | PMS1704220*## |
| 700 | 420 | 1100 | 2,5 | 22 | 33,5 | 42,5 | 150 | 375 | 20 | 2,6 | PMS1704250*## |
| 700 | 420 | 1100 | 3 | 33,5 | 35,5 | 42,5 | 150 | 450 | 22,5 | 2,6 | PMS1704300*## |
| 700 | 420 | 1100 | 3 | 28 | 37 | 42,5 | 150 | 450 | 22,5 | 2,6 | PMS1704300*##A |
| 700 | 420 | 1100 | 3,3 | 33,5 | 35,5 | 42,5 | 150 | 495 | 23 | 2,5 | PMS1704330*## |
| 700 | 420 | 1100 | 3,3 | 28 | 37 | 42,5 | 150 | 495 | 23 | 2,5 | PMS1704330*##A |
| 700 | 420 | 1100 | 4 | 33,5 | 35,5 | 42,5 | 150 | 600 | 24 | 2,1 | PMS1704400*## |
| 700 | 420 | 1100 | 4,7 | 30 | 45 | 42,5 | 150 | 600 | 29,5 | 1,7 | PMS1704470*##A |
| 700 | 420 | 1100 | 4,7 | 33 | 45 | 42,5 | 150 | 705 | 29,5 | 1,7 | PMS1704470*## (^) |
| 700 | 420 | 1100 | 5 | 30 | 45 | 42,5 | 150 | 750 | 30,5 | 1,7 | PMS1704500*##A |
| 700 | 420 | 1100 | 5 | 33 | 45 | 42,5 | 150 | 750 | 30,5 | 1,7 | PMS1704500*## (^) |
| 700 | 420 | 1100 | 5,6 | 33 | 45 | 42,5 | 150 | 840 | 32,5 | 1,6 | PMS1704560*## |
| 700 | 420 | 1100 | 6,8 | 30 | 45 | 57,5 | 100 | 680 | 29 | 2,2 | PMS1704680*## |
| 700 | 420 | 1100 | 9 | 35 | 50 | 57,5 | 100 | 900 | 34 | 1,8 | PMS1704900*## |
| 700 | 420 | 1100 | 10 | 38 | 57,5 | 57,5 | 100 | 1000 | 35,5 | 1,9 | PMS1705100*## |
| 700 | 420 | 1100 | 12 | 38 | 57,5 | 57,5 | 100 | 1200 | 37 | 1,7 | PMS1705120*## |
| 850 | 500 | 1300 | 1 | 17 | 28 | 42,5 | 200 | 200 | 14,5 | 3,6 | PMS1854100*## |
| 850 | 500 | 1300 | 1,2 | 22 | 30 | 42,5 | 200 | 240 | 16,5 | 3,2 | PMS1854120*##A |
| 850 | 500 | 1300 | 1,2 | 24,5 | 27,5 | 42,5 | 200 | 240 | 16,5 | 3,2 | PMS1854120*## |
| 850 | 500 | 1300 | 1,5 | 22 | 33,5 | 42,5 | 200 | 300 | 18,5 | 2,6 | PMS1854150*## |
| 850 | 500 | 1300 | 2,2 | 28 | 37 | 42,5 | 200 | 440 | 25 | 2,2 | PMS1854220*## |
| 850 | 500 | 1300 | 2,2 | 33,5 | 35,5 | 42,5 | 200 | 440 | 25 | 2,2 | PMS1854220*## |
| 850 | 500 | 1300 | 2,5 | 33,5 | 35,5 | 42,5 | 200 | 500 | 26 | 2 | PMS1854250*## |
| 850 | 500 | 1300 | 2,7 | 33,5 | 35,5 | 42,5 | 200 | 540 | 26,5 | 2 | PMS1854270*## |
| 850 | 500 | 1300 | 3 | 30 | 45 | 42,5 | 200 | 600 | 30 | 1,7 | PMS1854300*##A |
| 850 | 500 | 1300 | 3 | 33 | 45 | 42,5 | 200 | 600 | 30 | 1,7 | PMS1854300*## (^) |
| 850 | 500 | 1300 | 3,3 | 30 | 45 | 42,5 | 200 | 660 | 30,5 | 1,7 | PMS1854330*##A |
| 850 | 500 | 1300 | 3,3 | 33 | 45 | 42,5 | 200 | 660 | 30,5 | 1,7 | PMS1854330*## (^) |
| 850 | 500 | 1300 | 4 | 33 | 45 | 42,5 | 200 | 800 | 32 | 1,6 | PMS1854400*## |
| 850 | 500 | 1300 | 4,7 | 30 | 45 | 57,5 | 110 | 517 | 29 | 2,0 | PMS1854470*## |
| 850 | 500 | 1300 | 5 | 30 | 45 | 57,5 | 110 | 550 | 29,5 | 2,0 | PMS1854500*## |
| 850 | 500 | 1300 | 5,6 | 35 | 50 | 57,5 | 110 | 616 | 33 | 1,9 | PMS1854560*## |
| 850 | 500 | 1300 | 6 | 35 | 50 | 57,5 | 110 | 693 | 34 | 1,9 | PMS1854600*## |
| 850 | 500 | 1300 | 6,8 | 38 | 57,5 | 57,5 | 110 | 748 | 35 | 1,8 | PMS1854680*## |
| 850 | 500 | 1300 | 8 | 38 | 57,5 | 57,5 | 110 | 880 | 36,5 | 1,7 | PMS1854800*## |
| 1000 | 575 | 1550 | 0,68 | 17 | 28 | 42,5 | 225 | 153 | 14 | 4 | PMS2103680*## |
| 1000 | 575 | 1550 | 1 | 22 | 30 | 42,5 | 225 | 225 | 17 | 3,2 | PMS2104100*##A |
| 1000 | 575 | 1550 | 1 | 24,5 | 27,5 | 42,5 | 225 | 225 | 17 | 3,2 | PMS2104100*## |
| 1000 | 575 | 1550 | 1,2 | 22 | 33,5 | 42,5 | 225 | 270 | 18,5 | 2,9 | PMS2104120*## |

⁽¹⁾Change the * symbol with the needed capacitance tolerance code: J=±5%, K=±10%, M=±20% and the ## characters with the needed style code - ⁽²⁾Max. at 100kHz, +70°C for case operating T= +85°C (at T amb. >+70°C and T case >+85°C voltage and current de-rating must be observed), C tol. ≤±10% (for wider C tolerances, ESR variation must be taken in consideration)- ⁽³⁾Typical values at 100kHz (for operating frequencies far from the reference, ESR variation and related power dissipation variation must be taken in consideration) - ⁽⁴⁾Not suitable for across the line application

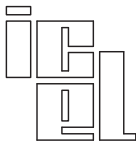

PMS - (New 550Vdc rating; expanded range; new lugs)

Metallized polypropylene film capacitor

MKP - Switching / Snubber - High current



| Ur Vdc | Urms Vac ⁽⁴⁾ | UpK Vdc | Cap. µF | Dimension in mm | | | du/dt V/µs | Ipeak A | Irms ⁽²⁾ A | ESR ⁽³⁾ mΩ | ICEL Code ⁽¹⁾ |
|-----------|----------------------------|------------|------------|-----------------|------|------|---------------|------------|--------------------------|--------------------------|--------------------------|
| | | | | B | H | L | | | | | |
| 1000 | 575 | 1550 | 1,5 | 28 | 37 | 42,5 | 225 | 337,5 | 23 | 2,5 | PMS2104150*## |
| 1000 | 575 | 1550 | 2 | 33,5 | 35,5 | 42,5 | 225 | 450 | 25,5 | 2,0 | PMS2104200*## |
| 1000 | 575 | 1550 | 2 | 30 | 45 | 42,5 | 225 | 450 | 27 | 2,0 | PMS2104200*##A |
| 1000 | 575 | 1550 | 2,2 | 30 | 45 | 42,5 | 225 | 495 | 28,5 | 1,9 | PMS2104220*## |
| 1000 | 575 | 1550 | 2,5 | 33 | 45 | 42,5 | 225 | 562,5 | 30,5 | 1,8 | PMS2104250*## |
| 1000 | 575 | 1550 | 3,3 | 30 | 45 | 57,5 | 135 | 445,5 | 29 | 2,2 | PMS2104330*## |
| 1000 | 575 | 1550 | 4,7 | 35 | 50 | 57,5 | 135 | 634,5 | 33,5 | 1,8 | PMS2104470*## |
| 1000 | 575 | 1550 | 5,6 | 38 | 57,5 | 57,5 | 135 | 756 | 35 | 1,7 | PMS2104560*## |
| 1000 | 575 | 1550 | 6 | 38 | 57,5 | 57,5 | 135 | 810 | 36 | 1,7 | PMS2104600*## |
| 1200 | 630 | 1750 | 0,47 | 17 | 28 | 42,5 | 255 | 119,8 | 12,5 | 4,9 | PMS2123470*## |
| 1200 | 630 | 1750 | 0,68 | 22 | 30 | 42,5 | 255 | 173 | 15 | 4,1 | PMS2123680*##A |
| 1200 | 630 | 1750 | 0,68 | 24,5 | 27,5 | 42,5 | 255 | 173 | 15 | 4,1 | PMS2123680*## |
| 1200 | 630 | 1750 | 1 | 28 | 37 | 42,5 | 255 | 255 | 19,5 | 3,2 | PMS2124100*## |
| 1200 | 630 | 1750 | 1,2 | 28 | 37 | 42,5 | 255 | 306 | 22 | 2,8 | PMS2124120*## |
| 1200 | 630 | 1750 | 1,5 | 33,5 | 35,5 | 42,5 | 255 | 382 | 24 | 2,4 | PMS2124150*## |
| 1200 | 630 | 1750 | 2 | 33 | 45 | 42,5 | 255 | 510 | 28,5 | 1,9 | PMS2124200*## |
| 1200 | 630 | 1750 | 2,2 | 33 | 45 | 42,5 | 255 | 561 | 29,5 | 1,8 | PMS2124220*## |
| 1200 | 630 | 1750 | 2,5 | 30 | 45 | 57,5 | 150 | 375 | 28,5 | 2,4 | PMS2124250*## |
| 1200 | 630 | 1750 | 3 | 35 | 50 | 57,5 | 150 | 450 | 32 | 2,0 | PMS2124300*## |
| 1200 | 630 | 1750 | 3,3 | 35 | 50 | 57,5 | 150 | 495 | 32,5 | 2,0 | PMS2124330*## |
| 1200 | 630 | 1750 | 4 | 38 | 57,5 | 57,5 | 150 | 600 | 34 | 1,9 | PMS2124400*## |
| 1200 | 630 | 1750 | 4,7 | 38 | 57,5 | 57,5 | 150 | 705 | 35,5 | 1,7 | PMS2124470*## |
| 1500 | 650 | 2200 | 0,33 | 17 | 28 | 42,5 | 320 | 105,6 | 12 | 5,3 | PMS2153330*##B |
| 1500 | 650 | 2200 | 0,33 | 24,5 | 27,5 | 42,5 | 320 | 105,6 | 12 | 5,3 | PMS2153330*## |
| 1500 | 650 | 2200 | 0,47 | 22 | 30 | 42,5 | 320 | 150,4 | 14,5 | 4,3 | PMS2153470*##A |
| 1500 | 650 | 2200 | 0,47 | 24,5 | 27,5 | 42,5 | 320 | 150,4 | 14,5 | 4,3 | PMS2153470*## |
| 1500 | 650 | 2200 | 0,68 | 33,5 | 35,5 | 42,5 | 320 | 217,6 | 18,5 | 3,6 | PMS2153680*## |
| 1500 | 650 | 2200 | 1 | 33,5 | 35,5 | 42,5 | 320 | 320 | 23,5 | 2,5 | PMS2154100*## |
| 1500 | 650 | 2200 | 1,2 | 30 | 45 | 42,5 | 320 | 384 | 27,5 | 2,1 | PMS2154120*## |
| 1500 | 650 | 2200 | 1,3 | 33 | 45 | 42,5 | 320 | 416 | 28,5 | 2,1 | PMS2154130*## |
| 1500 | 650 | 2200 | 1,5 | 30 | 45 | 57,5 | 175 | 262,5 | 25 | 3,0 | PMS2154150*## |
| 1500 | 650 | 2200 | 2 | 35 | 50 | 57,5 | 175 | 350 | 29 | 2,5 | PMS2154200*## |
| 1500 | 650 | 2200 | 2,2 | 35 | 50 | 57,5 | 175 | 385 | 29,5 | 2,4 | PMS2154220*## |
| 1500 | 650 | 2200 | 3 | 38 | 57,5 | 57,5 | 175 | 525 | 34 | 2 | PMS2154300*## |
| 2000 | 700 | 2600 | 0,22 | 17 | 28 | 42,5 | 410 | 90,2 | 11,5 | 6,4 | PMS2203220*##B |
| 2000 | 700 | 2600 | 0,22 | 24,5 | 27,5 | 42,5 | 410 | 90,2 | 11,5 | 6,4 | PMS2203220*## |
| 2000 | 700 | 2600 | 0,27 | 24,5 | 27,5 | 42,5 | 410 | 110,7 | 13 | 5,6 | PMS2203270*## |
| 2000 | 700 | 2600 | 0,33 | 22 | 30 | 42,5 | 410 | 135,3 | 14 | 4,6 | PMS2203330*## |
| 2000 | 700 | 2600 | 0,47 | 28 | 37 | 42,5 | 410 | 192,7 | 19 | 3,7 | PMS2203470*##A |
| 2000 | 700 | 2600 | 0,47 | 33,5 | 35,5 | 42,5 | 410 | 192,7 | 18,5 | 3,7 | PMS2203470*## |
| 2000 | 700 | 2600 | 0,56 | 33,5 | 35,5 | 42,5 | 410 | 229,6 | 21 | 3,3 | PMS2203560*## |
| 2000 | 700 | 2600 | 0,68 | 30 | 45 | 42,5 | 410 | 278,8 | 23,5 | 2,9 | PMS2203680*##A |
| 2000 | 700 | 2600 | 0,68 | 33 | 45 | 42,5 | 410 | 278,8 | 23,5 | 2,9 | PMS2203680*## (^^) |
| 2000 | 700 | 2600 | 0,82 | 33 | 45 | 42,5 | 410 | 336,2 | 25,5 | 2,6 | PMS2203820*## |
| 2000 | 700 | 2600 | 1 | 30 | 45 | 57,5 | 225 | 225 | 23 | 3,5 | PMS2204100*## |
| 2000 | 700 | 2600 | 1,5 | 35 | 50 | 57,5 | 225 | 337,5 | 27,5 | 2,7 | PMS2204150*## |
| 2000 | 700 | 2600 | 2 | 38 | 57,5 | 57,5 | 225 | 450 | 32 | 2,2 | PMS2204200*## |
| 2500 | 725 | 3300 | 0,1 | 17 | 28 | 42,5 | 550 | 55 | 8 | 11,7 | PMS2253100*## |
| 2500 | 725 | 3300 | 0,12 | 17 | 28 | 42,5 | 550 | 66 | 9 | 10,1 | PMS2253120*##B |
| 2500 | 725 | 3300 | 0,12 | 24,5 | 27,5 | 42,5 | 550 | 66 | 9 | 10,1 | PMS2253120*## |
| 2500 | 725 | 3300 | 0,15 | 24,5 | 27,5 | 42,5 | 550 | 82,5 | 10 | 8,3 | PMS2253150*## |
| 2500 | 725 | 3300 | 0,18 | 24,5 | 27,5 | 42,5 | 550 | 99 | 11,5 | 7,2 | PMS2253180*## |
| 2500 | 725 | 3300 | 0,22 | 22 | 33,5 | 42,5 | 550 | 121 | 13,5 | 6,0 | PMS2253220*## |
| 2500 | 725 | 3300 | 0,22 | 33,5 | 35,5 | 42,5 | 550 | 121 | 14 | 6,0 | PMS2253220*## |
| 2500 | 725 | 3300 | 0,33 | 33,5 | 35,5 | 42,5 | 550 | 181,5 | 17,5 | 4,4 | PMS2253330*## |
| 2500 | 725 | 3300 | 0,39 | 33,5 | 35,5 | 42,5 | 550 | 214,5 | 18,5 | 3,9 | PMS2253390*## |
| 2500 | 725 | 3300 | 0,47 | 33 | 45 | 42,5 | 550 | 258,5 | 22 | 3,4 | PMS2253470*## |
| 2500 | 725 | 3300 | 0,56 | 33 | 45 | 42,5 | 550 | 308 | 23 | 3,1 | PMS2253560*## |
| 2500 | 725 | 3300 | 0,68 | 30 | 45 | 57,5 | 280 | 190,4 | 22,5 | 3,8 | PMS2253680*## |
| 2500 | 725 | 3300 | 1 | 35 | 50 | 57,5 | 280 | 280 | 26,5 | 2,9 | PMS2254100*## |
| 2500 | 725 | 3300 | 1,2 | 38 | 57,5 | 57,5 | 280 | 330 | 29,5 | 2,7 | PMS2254120*## |

⁽¹⁾Change the * symbol with the needed capacitance tolerance code: J=±5%, K=±10%, M=±20% and the ## characters with the needed style code - ⁽²⁾Max. at 100kHz, +70°C for case operating T = +85°C (at T amb. >+70°C and T case >+85°C voltage and current de-rating must be observed), C tol. ±10% (for wider C tolerances, ESR variation must be taken in consideration) - ⁽³⁾Typical values at 100kHz (for operating frequencies far from the reference, ESR variation and related power dissipation variation must be taken in consideration) - ⁽⁴⁾Not suitable for across the line application

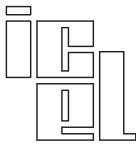

PMS - (New 550Vdc rating; expanded range; new lugs)
Metallized polypropylene film capacitor
MKP - Switching / Snubber - High current



| Ur Vdc | Urms Vac ⁽⁴⁾ | UpK Vdc | Cap. μF | Dimension in mm | | | du/dt V/μs | Ipeak A | Irms ⁽²⁾ A | ESR ⁽³⁾ mΩ | ICEL Code ⁽¹⁾ |
|-----------|----------------------------|------------|------------|-----------------|------|------|---------------|------------|--------------------------|--------------------------|--------------------------|
| | | | | B | H | L | | | | | |
| 3000 | 750 | 4000 | 0,068 | 17 | 28 | 42,5 | 750 | 51 | 8 | 14,5 | PMS2302680*##B |
| 3000 | 750 | 4000 | 0,068 | 24,5 | 27,5 | 42,5 | 750 | 51 | 8 | 14,5 | PMS2302680*## |
| 3000 | 750 | 4000 | 0,1 | 22 | 30 | 42,5 | 750 | 75 | 10 | 9,9 | PMS2303100*##A |
| 3000 | 750 | 4000 | 0,1 | 24,5 | 27,5 | 42,5 | 750 | 75 | 10 | 9,9 | PMS2303100*## |
| 3000 | 750 | 4000 | 0,12 | 22 | 33,5 | 42,5 | 750 | 90 | 11 | 8,8 | PMS2303120*##B |
| 3000 | 750 | 4000 | 0,12 | 33,5 | 35,5 | 42,5 | 750 | 90 | 11 | 8,8 | PMS2303120*## |
| 3000 | 750 | 4000 | 0,15 | 33,5 | 35,5 | 42,5 | 750 | 112,5 | 13,5 | 7,3 | PMS2303150*## |
| 3000 | 750 | 4000 | 0,18 | 28 | 37 | 42,5 | 750 | 135 | 15 | 6,3 | PMS2303150*##A |
| 3000 | 750 | 4000 | 0,18 | 33,5 | 35,5 | 42,5 | 750 | 135 | 14,5 | 6,3 | PMS2303180*## |
| 3000 | 750 | 4000 | 0,22 | 30 | 45 | 42,5 | 750 | 165 | 17,5 | 5,3 | PMS2303220*##A |
| 3000 | 750 | 4000 | 0,22 | 33 | 45 | 42,5 | 750 | 165 | 17,5 | 5,3 | PMS2303220*## (^^) |
| 3000 | 750 | 4000 | 0,3 | 33 | 45 | 42,5 | 750 | 225 | 20,5 | 4,2 | PMS2303300*## |
| 3000 | 750 | 4000 | 0,39 | 30 | 45 | 57,5 | 370 | 144,3 | 19 | 5,2 | PMS2303390*## |
| 3000 | 750 | 4000 | 0,47 | 35 | 50 | 57,5 | 370 | 173,9 | 21,5 | 4,6 | PMS2303470*## |
| 3000 | 750 | 4000 | 0,56 | 35 | 50 | 57,5 | 370 | 207,2 | 23 | 4,1 | PMS2303560*## |
| 3000 | 750 | 4000 | 0,68 | 38 | 57,5 | 57,5 | 370 | 251,6 | 27 | 3,5 | PMS2303560*## |

⁽¹⁾Change the * symbol with the needed capacitance tolerance code: J=±5%, K=±10%, M=±20% and the ## characters with the needed style code - ⁽²⁾Max. at 100kHz, +70°C for case operating T= +85°C (at T amb. >+70°C and T case >+85°C voltage and current de-rating must be observed), C tol. ≤±10% (for wider C tolerances, ESR variation must be taken in consideration)- ⁽³⁾Typical values at 100kHz (for operating frequencies far from the reference, ESR variation and related power dissipation variation must be taken in consideration) - ⁽⁴⁾Not suitable for across the line application