

MHBA - (Expanded range; new lugs)
Metallized polypropylene film capacitor
MKP - Switching - High current - AC
2/4/6 x Wire or lug terminals - Small size

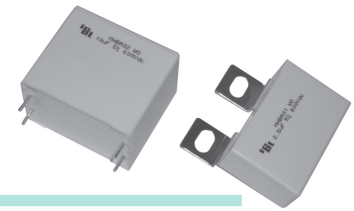

Main applications

Switching capacitor for industrial and motor speed controls, high frequency electronic ballasts, switching mode power supplies, resonant circuits, induction heaters, input-output AC filtering, AC applications

Dielectric

Polypropylene

Electrodes

Vacuum deposited metal layers

Coating

Solvent resistant plastic case with resin sealing (UL 94 V-0). Flame retardant execution

Construction

Extended metallized film (refer to general technical information)

Terminals

Tinned copper wire (lead-free). 2x terminals (S=5±1mm, L=25±5mm leads length), 4x terminals (SD=5,5±1,5mm), 6x terminals (ST=5,5±1.5mm) or ltinned copper (brass) lug terminals (lead-free) execution (please refer to article table)

Degree of protection

IP00

Installation

Whatever position assuring correct heat dissipation. Arrangement of many components with box walls in contact not admitted; suggested minimum distance between side by side elements ≥ 1/8 of the box thickness (B size). Box with lugs terminals must be free to correctly dissipate from all the body faces

Reference standard

IEC 61071, IEC 60068, RoHS compliant

Climatic category

40/85/56 (IEC 60068/1), GPD (DIN40040)

Operating temperature range (case)

-40°...+85°C (+100°C observing voltage and current de-rating)

Max. permissible ambient temperature

+70°C, operation at rated power, current, voltage and natural cooling (+85°C observing voltage and current de-rating)

Rated capacitance (Cr)

0,47µF to 75µF. Refer to article table

Capacitance tolerance (at 1kHz)

±10% (code=K), ±5% (code=J). Other tolerances upon request

Capacitance temperature coefficient

Refer to graphs in general technical information

Long term stability (at 1 kHz)

Capacitance variation ≤ ±1% after a period of 2 years at standard environmental conditions

Rated voltage (Ur)

370, 500, 600, 700, 800 Vdc

Temperature de-rated voltage

For operating temperature (case) > +85°C,
 Ur must be decreased 1,5% for every °C exceeding +85°C
 Urms must be decreased 2,5% for every °C exceeding +85°C

Permissible AC voltage (Urms)

160, 250, 330, 380, 400 Vac

Non recurrent surge voltage (Upk)

470, 625, 750, 875, 1050Vdc

Self inductance

≤ 1nH/mm of fixing pitch

Maximum pulse rise time

Refer to article table

Maximum peak current (Ipeak)

Refer to article table. Max. non repetitive Ipk = 1,5 x Ipeak

Dissipation factor (DF), max.

Tgδ x10⁻⁴, measured at 25±5°C, 1kHz

Cr≤5µF	5µF<Cr≤15µF	15µF<Cr≤30µF	30µF<Cr≤60µF	Cr>60µF
6	10	13	15	17

Insulation resistance (IR)

≥ 30000s when measured between terminals, at 25±°C, after 1 minute of electrification at 100Vdc

Test voltage between terminals (Ut)

1,6xUr (DC) applied for 10s / 2xUr (DC) applied for 2s, at 25±5°C

Test voltage between terminals and case (Utc)

3kV 50+60Hz applied for 60s at 25±5°C

Damp heat test (steady state)

Test conditions:
 Temperature= +40±2°C
 Relative humidity=93±2%
 Test duration= 56 days

Performance:
 Capacitance change ≤ ±2%
 DF change ≤ 0.0010 at 1kHz
 IR≥ 50% of initial limit value

Typical capacitance change versus operating time

-3% after 30'000 hours at Urms or after 100'000 hours at Ur

Life expectancy

≥ 100'000 hours (Ur); 30'000 hours (Urms)

Failure quota

300/10⁹ component hours

Resistance to soldering heat test

Test conditions:
 Solder bath temperature= +260±5°C
 Dipping time (with heat screen)= 10±1s

Performance:
 Capacitance change ≤ ±1%
 DF change ≤ 0.0010 at 1kHz
 IR≥ 50% of initial limit value

Warning: this specification must be completed with the data given in the "General technical information" chapter

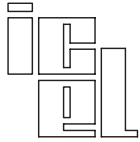

MHBA - (expanded range; new lugs)

Metallized polypropylene film capacitor
MKP - Switching - High current - AC
2/4/6 x Wire or lug terminals - Small size



Dimensions in mm (drawings not in scale)

Style SP-SPM8 / SR-SRM8

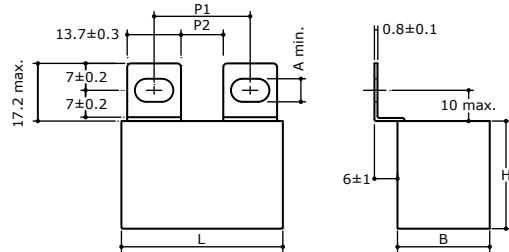

Style VP-VPM8 / VR-VRM8

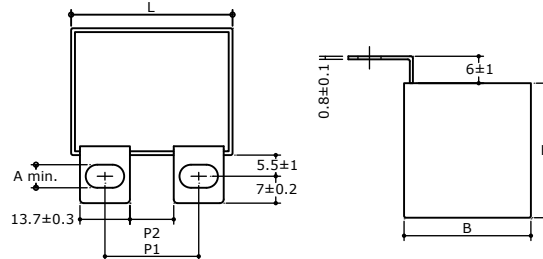

Style FP-FPM8 / FR-FRM8

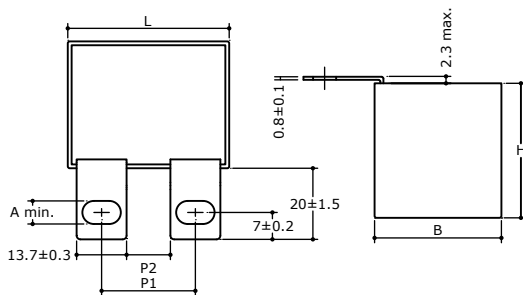

Fixing pitch and distance between lugs (mm)			
Lugs style	L	P1	P2
SP-SPM8	42±42,5	23±28(M6) 25±26(M8)	11min.
VP-VPM8	57,5	37±42(M6) 39±40(M8)	24min.
FP-FPM8			
SR-SRM8	42±42,5	20±25(M6) 22±23(M8)	8min.
VR-VRM8	57.5	34±39(M6) 36±37(M8)	21min.
FR-FRM8			

Fixing slot size (mm)**	
SP, VP, FP, SR, VR, FR	A=6min.
SPM8, VPM8, FPM8, SRM8, VRM8, FRM8	A=8min.

** Standard fixing slots for M6 screws, slots for M8 screws available upon request

Style SN-SNM8 (for L=57.5mm only)

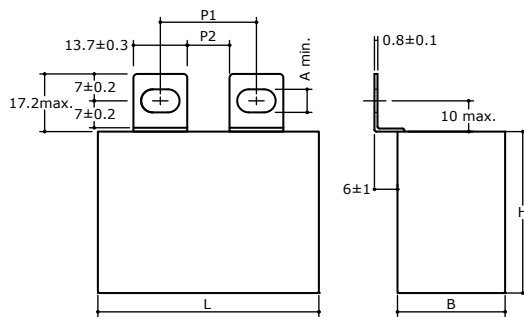

Style VN-VNM8 (for L=57.5mm only)

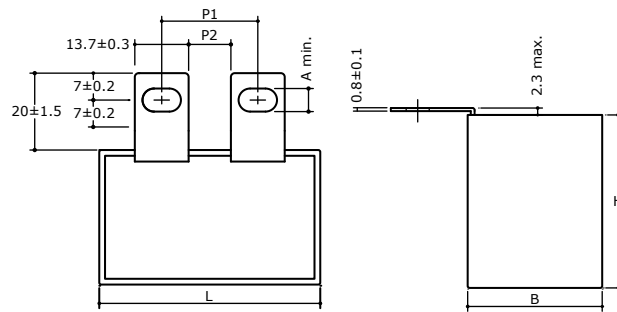

Fixing pitch and distance between lugs (mm)			
Lugs style	L	P1	P2
SN-SNM8	42±42,5	Not available	
VN-VNM8	57.5	23±28(M6) 25±26(M8)	11min.

Fixing slot size (mm)**	
SN, VN	A= 6min.
SNM8, VNM8	A= 8min.

** Standard fixing slots for M6 screws, slots for M8 screws available upon request

Style AP

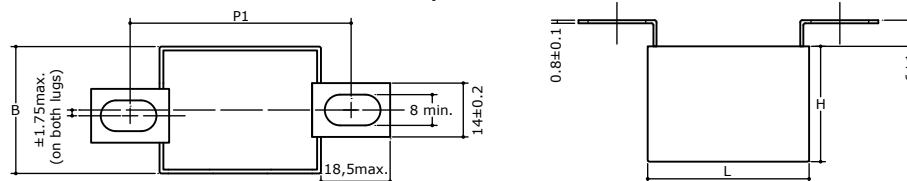

Fixing pitch and distance between lugs (mm)			
Lugs style	L	P1	P2
AP	42±42,5	51±64 (M8)	-
	57.5	65±78 (M8)	-

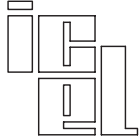

MHBA - (expanded range; new lugs)
Metallized polypropylene film capacitor
MKP - Switching - High current - AC
2/4/6 x Wire or lug terminals - Small size



Dimensions in mm (drawings not in scale)

Style BP (Not available for L=57.5mm)

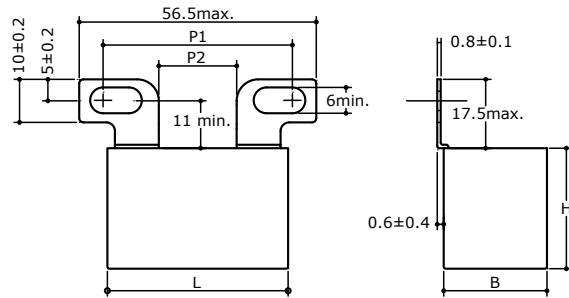

Fixing pitch and distance between lugs (mm)			
Lugs style	L	P1	P2
BP	42+42.5	32+45 (M6)	17min.
	57.5	Not available	

Style SL (M8 slots only)

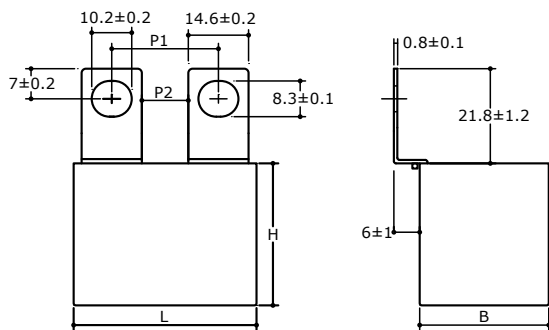

Fixing pitch and distance between lugs (mm)			
Lugs style	L	P1	P2
SL	42+42.5	22+24 (M8)	8min.
	57.5	36+38 (M8)	21min.

Style BN (M6 slots only; not available for L=57.5mm and for L=42+42.5mm having B>22mm)

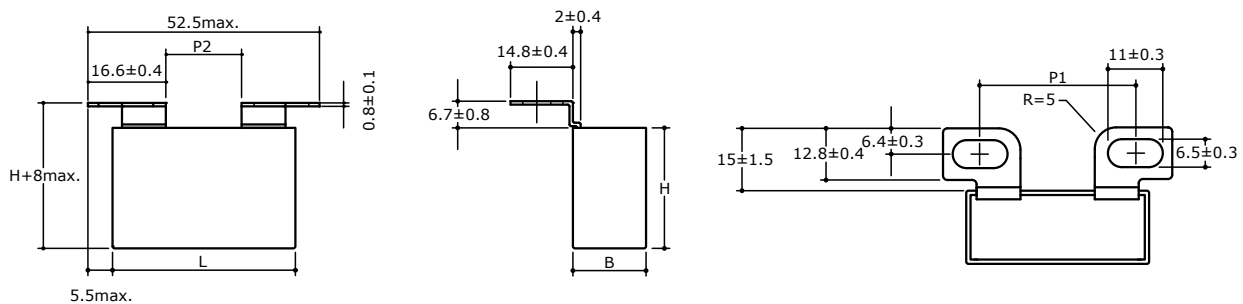

Fixing pitch and distance between lugs (mm)			
Lugs style	L	P1	P2
BN	42+42.5	30+37 (M6)	15min.
		Not available for B>22	
	57.5	Not available	

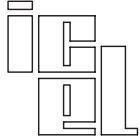

MHBA - (expanded range; new lugs)
Metallized polypropylene film capacitor
MKP - Switching - High current - AC
2/4/6 x Wire or lug terminals - Small size



2 terminals execution

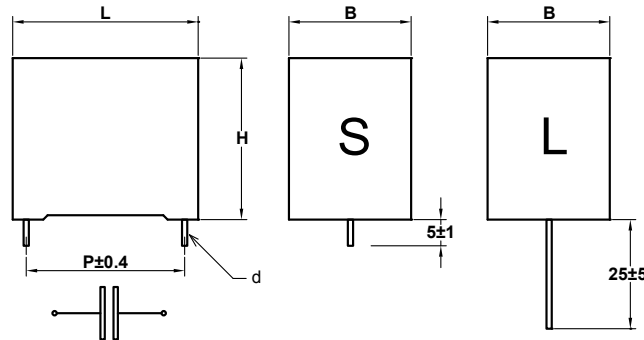

4 terminals execution

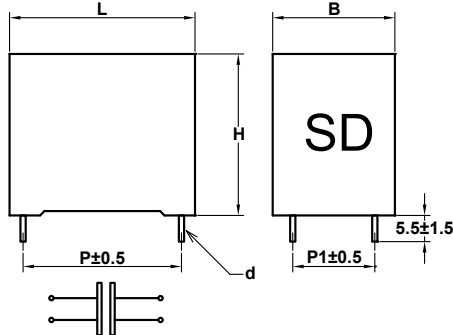

6 terminals execution

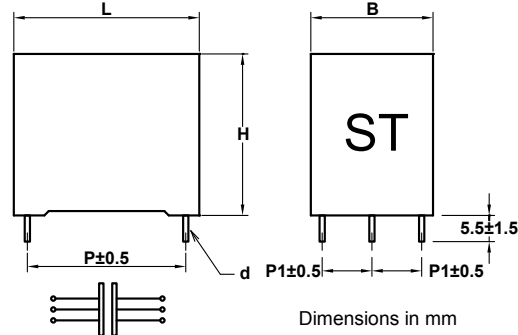

Dimensions in mm

MHBA article table (different values available upon request)

Ur Vdc	Urms Vac	Upkr Vdc	Cap. µF	Dimension in mm						du/dt V/µs	Ipeak A	Irms ⁽²⁾ A	ESR ⁽³⁾ mΩ	ICEL Code ⁽¹⁾
				B	H	L	d	P	P1					
370	160	470	3	11	20	32	0,8	27,5	-	55	165	5	13,7	MHBA044300*H#
370	160	470	4	13	22	32	1	27,5	-	55	220	6	11,3	MHBA044400*H#
370	160	470	5	14	28	32	1	27,5	-	55	275	7,5	9,9	MHBA044500*H#
370	160	470	6,8	18	33	32	1,2	27,5	-	55	374	10	8,3	MHBA044680*H#
370	160	470	6,8	18	33	32	1,2	27,5	5,1	55	374	12	7,6	MHBA044680*HSD
370	160	470	10	22	37	32	1,2	27,5	-	55	550	13	6	MHBA045100*H#
370	160	470	10	22	37	32	1,2	27,5	10,2	55	550	15	5,3	MHBA045100*HSD
370	160	470	10	17	28	42,5	1,2	37,5	-	37,5	375	10,5	6,9	MHBA045100*J#
370	160	470	10	17	28	42,5	see lugs drawing	37,5	37,5	37,5	375	12,5	6,1	MHBA045100*§§
370	160	470	15	22	30	42,5	1,2	37,5	-	37,5	562,5	12,5	5,7	MHBA045150*J#
370	160	470	15	22	30	42,5	1,2	37,5	10,2	37,5	562,5	14	5,1	MHBA045150*JSD
370	160	470	15	22	30	42,5	see lugs drawing	37,5	562,5	15	5	5	5	MHBA045150*§§
370	160	470	20	20	40	41,5	1,2	37,5	-	37,5	750	14	5	MHBA045200*J#
370	160	470	20	20	40	41,5	1,2	37,5	10,2	37,5	750	17	4,4	MHBA045200*JSD
370	160	470	22	28	37	42,5	1,2	37,5	-	37,5	825	14	4,7	MHBA045220*J#
370	160	470	22	28	37	42,5	1,2	37,5	10,2	37,5	825	17,5	4,1	MHBA045220*JSD
370	160	470	22	28	37	42,5	see lugs drawing	37,5	825	19,5	4	4	4	MHBA045220*§§
370	160	470	25	24	44	41,5	1,2	37,5	-	37,5	937,5	14	4,3	MHBA045250*J#
370	160	470	25	24	44	41,5	1,2	37,5	10,2	37,5	937,5	20,5	3,7	MHBA045250*JSD
370	160	470	33	30	45	42,5	1,2	37,5	-	37,5	1237,5	14	4	MHBA045330*J#
370	160	470	33	30	45	42,5	1,2	37,5	20,3	37,5	1237,5	22	3,4	MHBA045330*JSD
370	160	470	33	30	45	42,5	see lugs drawing	37,5	1237,5	24	3,3	3,3	3,3	MHBA045330*§§
370	160	470	40	30	45	57,5	1,2	52,5	-	25	1000	14	4,5	MHBA045400*R#
370	160	470	40	30	45	57,5	1,2	52,5	20,3	25	1000	22	3,9	MHBA045400*RSD
370	160	470	40	30	45	57,5	see lugs drawing	25	1000	24	3,8	3,8	3,8	MHBA045400*§§
370	160	470	50	35	50	57,5	1,2	52,5	-	25	1250	14	3,9	MHBA045500*R#
370	160	470	50	35	50	57,5	1,2	52,5	20,3	25	1250	25	3,3	MHBA045500*RSD
370	160	470	50	35	50	57,5	see lugs drawing	25	1250	27,5	3,2	3,2	3,2	MHBA045500*§§
370	160	470	60	35	50	57,5	1,2	52,5	-	25	1500	14	3,6	MHBA045600*R#
370	160	470	60	35	50	57,5	1,2	52,5	20,3	25	1500	26	3	MHBA045600*RSD
370	160	470	60	35	50	57,5	see lugs drawing	25	1500	29	2,9	2,9	2,9	MHBA045600*§§
370	160	470	68	38	57,5	57,5	1,2	52,5	20,3	25	1700	27	2,8	MHBA045680*RSD
370	160	470	68	38	57,5	57,5	1,2	52,5	10,2	25	1700	28,5	2,7	MHBA045680*RST
370	160	470	68	38	57,5	57,5	see lugs drawing	25	1700	30,5	2,7	2,7	2,7	MHBA045680*§§
370	160	470	75	38	57,5	57,5	1,2	52,5	20,3	25	1875	27	2,7	MHBS405750*RSD
370	160	470	75	38	57,5	57,5	1,2	52,5	10,2	25	1875	29,5	2,6	MHBS405750*RST
370	160	470	75	38	57,5	57,5	see lugs drawing	25	1875	31,5	2,6	2,6	2,6	MHBA045750*§§

⁽¹⁾Change the * symbol with the needed Cap. tol. code: J=±5%, K=±10%, the # symbol with S for 5mm, L for 25mm lead length and §§ symbols with needed lugs style - ⁽²⁾Max. at 100kHz, +70°C for case operating T= +85°C (at T amb. >+70°C and T case>+85°C voltage and Irms de-rating must be observed), C tol. ≤±10% (for wider C tolerance, ESR variation must be taken in consideration) - ⁽³⁾Typical values at 100kHz (for operating frequencies far from the reference, ESR variation and related power dissipation variation must be taken in consideration) - ⁽⁴⁾Not suitable for across the line application

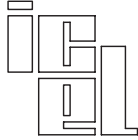

MHBA - (expanded range; new lugs)
Metallized polypropylene film capacitor
MKP - Switching - High current - AC
2/4/6 x Wire or lug terminals - Small size



Ur Vdc	Urms Vac	Upkr Vdc	Cap. µF	Dimension in mm							du/dt V/µs	Ipeak A	Irms ⁽²⁾ A	ESR ⁽³⁾ mΩ	ICEL Code ⁽¹⁾
				B	H	L	d	P	P1						
500	250	625	1,5	11	20	32	0,8	27,5	-	70	105	4,5	17,2	MHBA034150*H#	
500	250	625	2	13	22	32	1	27,5	-	70	140	6	14,3	MHBA034200*H#	
500	250	625	2,2	13	22	32	1	27,5	-	70	154	6	13,6	MHBA034220*H#	
500	250	625	3,3	15	24,5	32	1	27,5	-	70	231	7	11	MHBA034330*H#	
500	250	625	4	18	33	32	1,2	27,5	-	70	280	8,5	9,9	MHBA034400*H#	
500	250	625	5	18	33	32	1,2	27,5	-	70	350	9,5	8,7	MHBA034500*H#	
500	250	625	5	18	33	32	1,2	27,5	5,1	70	350	11	8	MHBA034500*HSD	
500	250	625	6,8	22	37	32	1,2	27,5	-	70	476	12	7,7	MHBA034680*H#	
500	250	625	6,8	22	37	32	1,2	27,5	10,2	70	476	14	7	MHBA033680*HSD	
500	250	625	7,5	22	30	42,5	1,2	37,5	-	47,5	356,2	10	8,3	MHBA034750*H#	
500	250	625	7,5	22	30	42,5	see lugs drawing	-	-	47,5	356,2	11,5	7,5	MHBA034750*SS	
500	250	625	10	22	33,5	42,5	1,2	37,5	-	47,5	475	12	6,7	MHBA035100*J#	
500	250	625	10	22	33,5	42,5	1,2	37,5	10,2	47,5	475	13,5	6,1	MHBA035100*JSD	
500	250	625	10	22	33,5	42,5	see lugs drawing	-	-	47,5	475	14,5	6	MHBA035100*SS	
500	250	625	12,5	20	40	41,5	1,2	37,5	-	47,5	593,7	14	6,1	MHBA035125*J#	
500	250	625	12,5	20	40	41,5	1,2	37,5	10,2	47,5	593,7	16	5,5	MHBA035125*JSD	
500	250	625	15	28	37	42,5	1,2	37,5	-	47,5	712,5	14	5,4	MHBA035150*J#	
500	250	625	15	28	37	42,5	1,2	37,5	20,3	47,5	712,5	16,5	4,8	MHBA035150*JSD	
500	250	625	15	28	37	42,5	see lugs drawing	-	-	47,5	712,5	17,5	4,7	MHBA035150*SS	
500	250	625	17,5	24	44	41,5	1,2	37,5	-	47,5	831,2	14	5	MHBA035175*J#	
500	250	625	17,5	24	44	41,5	1,2	37,5	10,2	47,5	831,2	19	4,4	MHBA035175*JSD	
500	250	625	22	30	45	42,5	1,2	37,5	-	47,5	1045	14	4,5	MHBA035220*J#	
500	250	625	22	30	45	42,5	1,2	37,5	20,3	47,5	1045	19,5	3,9	MHBA035220*JSD	
500	250	625	22	30	45	42,5	see lugs drawing	-	-	47,5	1045	21,5	3,8	MHBA035220*SS	
500	250	625	25	30	45	57,5	1,2	52,5	-	32,5	812,5	14	5	MHBA035250*R#	
500	250	625	25	30	45	57,5	1,2	52,5	20,3	32,5	812,5	20	4,4	MHBA035250*RSD	
500	250	625	25	30	45	57,5	see lugs drawing	-	-	32,5	812,5	22	4,3	MHBA035250*SS	
500	250	625	30	30	45	57,5	1,2	52,5	-	32,5	975	14	4,5	MHBA035300*R#	
500	250	625	30	30	45	57,5	1,2	52,5	20,3	32,5	975	22	3,9	MHBA035300*RSD	
500	250	625	30	30	45	57,5	see lugs drawing	-	-	32,5	975	24	3,8	MHBA035300*SS	
500	250	625	40	35	50	57,5	1,2	52,5	-	32,5	1300	14	3,9	MHBA035400*R#	
500	250	625	40	35	50	57,5	1,2	52,5	20,3	32,5	1300	25	3,3	MHBA035400*RSD	
500	250	625	40	35	50	57,5	see lugs drawing	-	-	32,5	1300	28	3,2	MHBA035400*SS	
500	250	625	47	38	57,5	57,5	1,2	52,5	20,3	32,5	1527,5	26,5	3,1	MHBA035470*RSD	
500	250	625	47	38	57,5	57,5	see lugs drawing	-	-	32,5	1527,5	29	3	MHBA035470*SS	
500	250	625	55	38	57,5	57,5	1,2	52,5	20,3	32,5	1625	27	2,9	MHBA035550*RSD	
500	250	625	55	38	57,5	57,5	1,2	52,5	10,2	32,5	1625	28,5	2,8	MHBA035550*RST	
500	250	625	55	38	57,5	57,5	see lugs drawing	-	-	32,5	1625	30	2,8	MHBA035550*SS	
600	330	750	1,2	11	20	32	0,8	27,5	-	90	108	5	16,7	MHBA024120*H#	
600	330	750	1,5	13	22	32	1	27,5	-	90	135	6	13,5	MHBA024150*H#	
600	330	750	2	15	24,5	32	1	27,5	-	90	180	7	11,5	MHBA024200*H#	
600	330	750	2,2	15	24,5	32	1	27,5	-	90	198	7	10,7	MHBA024220*H#	
600	330	750	2,5	14	28	32	1	27,5	-	90	225	8	10,1	MHBA024250*H#	
600	330	750	3,3	18	33	32	1,2	27,5	-	90	297	10	8,7	MHBA024330*H#	
600	330	750	3,3	18	33	32	1,2	27,5	5,1	90	297	11,5	8	MHBA024330*HSD	
600	330	750	4	18	33	32	1,2	27,5	-	90	360	11	7,7	MHBA024400*H#	
600	330	750	4	18	33	32	1,2	27,5	10,2	90	360	12,5	7	MHBA024400*HSD	
600	330	750	4	17	28	42,5	1,2	37,5	-	60	240	9,5	8,9	MHBA024400*J#	
600	330	750	4	17	28	42,5	see lugs drawing	-	-	60	240	11	8,2	MHBA024400*SS	
600	330	750	5	22	37	32	1,2	27,5	-	90	450	12	7	MHBA024500*H#	
600	330	750	5	22	37	32	1,2	27,5	10,2	90	450	14	6,3	MHBA024500*HSD	
600	330	750	5	22	30	42,5	1,2	37,5	-	60	300	11,5	7,3	MHBA024500*J#	
600	330	750	5	22	30	42,5	see lugs drawing	-	-	60	300	13	6,6	MHBA024500*SS	
600	330	750	6,8	22	33,5	42,5	1,2	37,5	-	60	408	12,5	6,4	MHBA024680*J#	
600	330	750	6,8	22	33,5	42,5	see lugs drawing	-	-	60	408	15	5,7	MHBA024680*SS	
600	330	750	8,2	20	40	41,5	1,2	37,5	-	60	492	14	5,9	MHBA024820*J#	
600	330	750	8,2	20	40	41,5	1,2	37,5	10,2	60	492	16,5	5,3	MHBA024820*JSD	
600	330	750	10	28	37	42,5	1,2	37,5	-	60	600	14	5,4	MHBA025100*J#	
600	330	750	10	28	37	42,5	1,2	37,5	10,2	60	600	16,5	4,8	MHBA025100*JSD	
600	330	750	10	28	37	42,5	see lugs drawing	-	-	60	600	18,5	4,7	MHBA025100*SS	
600	330	750	12	24	44	41,5	1,2	37,5	-	60	720	14	5	MHBA025120*J#	
600	330	750	12	24	44	41,5	1,2	37,5	10,2	60	720	19	4,4	MHBA025120*JSD	
600	330	750	15	30	45	42,5	1,2	37,5	-	60	900	14	4,4	MHBA025150*J#	
600	330	750	15	30	45	42,5	1,2	37,5	20,3	60	900	21	3,8	MHBA025150*JSD	
600	330	750	15	30	45	42,5	see lugs drawing	-	-	60	900	23	3,7	MHBA025150*SS	
600	330	750	20	30	45	57,5	1,2	52,5	-	40	800	14	4,7	MHBA025200*R#	
600	330	750	20	30	45	57,5	1,2	52,5	20,3	40	800	21	4,1	MHBA025200*R#	
600	330	750	20	30	45	57,5	see lugs drawing	-	-	40	800	23	4	MHBA025200*SS	
600	330	750	25	35	50	57,5	1,2	52,5	-	40	1000	14	4,2	MHBA025250*R#	
600	330	750	25	35	50	57,5	1,2	52,5	20,3	40	1000	24,5	3,6	MHBA025250*RSD	
600	330	750	25	35	50	57,5	see lugs drawing	-	-	40	1000	27	3,5	MHBA025250*SS	

⁽¹⁾Change the * symbol with the needed Cap. tol. code: J=±5%, K=±10%, the # symbol with S for 5mm, L for 25 mm lead length and §§ symbols with needed lugs style - ⁽²⁾ Max. at 100kHz, +70°C for case operating T= +85°C (at T amb. >+70°C and T case>+85°C voltage and Irms de-rating must be observed), C tol. ≤±10% (for wider C tolerance, ESR variation must be taken in consideration) - ⁽³⁾ Typical values at 100kHz (for operating frequencies far from the reference, ESR variation and related power dissipation variation must be taken in consideration) - ⁽⁴⁾Not suitable for across the line application

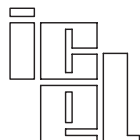

MHBA - (expanded range; new lugs)

Metallized polypropylene film capacitor
MKP - Switching - High current - AC
2/4/6 x Wire or lug terminals - Small size

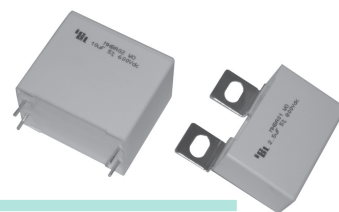

Ur Vdc	Urms Vac	Upkr Vdc	Cap. µF	Dimension in mm							du/dt V/µs	Ipeak A	Irms ⁽²⁾ A	ESR ⁽³⁾ mΩ	ICEL Code ⁽¹⁾
				B	H	L	d	P	P1						
600	330	750	33	38	57,5	57,5	1,2	52,5	20,3	40	1320	26,5	3,1	MHBA025330*RSD	
600	330	750	33	38	57,5	57,5	1,2	52,5	10,2	40	1320	27,5	3	MHBA025330*RST	
600	330	750	33	38	57,5	57,5				see lugs drawing	40	1320	29	3	MHBA025330*SS
700	380	875	0,68	11	20	32	0,8	27,5	-	110	74,8	3,5	20,5	MHBA063680*H#	
700	380	875	1	13	22	32	1	27,5	-	110	110	5,5	15,5	MHBA064100*H#	
700	380	875	1,5	15	24,5	32	1	27,5	-	110	165	6,5	12,5	MHBA064150*H#	
700	380	875	2	14	28	32	1	27,5	-	110	220	7,5	10,6	MHBA064200*H#	
700	380	875	3	18	33	32	1,2	27,5	-	110	330	10	8,6	MHBA064300*H#	
700	380	875	3	18	33	32	1,2	27,5	5,1	110	330	11,5	7,9	MHBA064300*HSD	
700	380	875	3	17	28	42,5	1,2	37,5	-	75	225	9	9,9	MHBA064300*J#	
700	380	875	3	17	28	42,5				see lugs drawing	75	225	10,5	9,2	MHBA064300*SS
700	380	875	4	22	37	32	1,2	27,5	-	110	440	12	7,4	MHBA064400*H#	
700	380	875	4	22	37	32	1,2	27,5	10,2	110	440	14	6,7	MHBA064400*HSD	
700	380	875	4	22	30	42,5	1,2	37,5	-	75	300	10,5	8,5	MHBA064400*J#	
700	380	875	4	22	30	42,5				see lugs drawing	75	300	12	7,8	MHBA064400*SS
700	380	875	5	22	33,5	42,5	1,2	37,5	-	75	375	12	7,3	MHBA064500*J#	
700	380	875	5	22	33,5	42,5				see lugs drawing	75	375	13,5	6,6	MHBA064500*SS
700	380	875	6,8	20	40	41,5	1,2	37,5	-	75	510	14	6,4	MHBA064680*J#	
700	380	875	6,8	20	40	41,5	1,2	37,5	10,2	75	510	15,5	5,8	MHBA064680*JSD	
700	380	875	8	28	37	42,5	1,2	37,5	-	75	600	14	5,8	MHBA064800*J#	
700	380	875	8	28	37	42,5	1,2	37,5	10,2	75	600	16	5,2	MHBA064800*JSD	
700	380	875	8	28	37	42,5				see lugs drawing	75	600	17,5	5,1	MHBA064800*SS
700	380	875	10	30	45	42,5	1,2	37,5	-	75	750	14	5,3	MHBA065100*J#	
700	380	875	10	30	45	42,5	1,2	37,5	20,3	75	750	19	4,7	MHBA065100*JSD	
700	380	875	10	30	45	42,5				see lugs drawing	75	750	20,5	4,6	MHBA065100*SS
700	380	875	15	30	45	57,5	1,2	52,5	-	50	750	14	5,4	MHBA065150*R#	
700	380	875	15	30	45	57,5	1,2	52,5	20,3	50	750	19,5	4,8	MHBA065150*RSD	
700	380	875	15	30	45	57,5				see lugs drawing	50	750	21,5	4,7	MHBA065150*SS
700	380	875	20	35	50	57,5	1,2	52,5	-	50	1000	14	4,7	MHBA065200*R#	
700	380	875	20	35	50	57,5	1,2	52,5	20,3	50	1000	23	4,1	MHBA065200*RSD	
700	380	875	20	35	50	57,5				see lugs drawing	50	1000	25	4	MHBA065200*SS
700	380	875	25	38	57,5	57,5	1,2	52,5	20,3	50	1250	25	3,6	MHBA065250*RSD	
700	380	875	25	38	57,5	57,5	1,2	52,5	10,2	50	1250	26	3,5	MHBA065250*RST	
700	380	875	25	38	57,5	57,5				see lugs drawing	50	1250	27	3,5	MHBA065250*SS
800	400	1050	0,47	11	20	32	0,8	27,5	-	120	56,4	3	22,8	MHBA013470*H#	
800	400	1050	0,56	11	20	32	0,8	27,5	-	120	67,2	4	19,2	MHBA013560*H#	
800	400	1050	0,68	13	22	32	0,8	27,5	-	120	81,6	5	16,8	MHBA013680*H#	
800	400	1050	1	15	24,5	32	1	27,5	-	120	120	6,5	13,8	MHBA014100*H#	
800	400	1050	1,5	18	33	32	1	27,5	-	120	180	8,5	11,1	MHBA014150*H#	
800	400	1050	2,2	18	33	32	1	27,5	-	120	264	9,5	9,1	MHBA014220*H#	
800	400	1050	2,5	17	28	42,5	1,2	37,5	-	82,5	206,2	9	9,8	MHBA014250*J#	
800	400	1050	2,5	17	28	42,5				see lugs drawing	82,5	206,2	10,5	9,1	MHBA014250*SS
800	400	1050	3	22	37	32	1,2	27,5	-	120	360	12	7,8	MHBA014300*H#	
800	400	1050	3	22	37	32	1,2	27,5	10,2	120	360	13,5	7,1	MHBA014300*HSD	
800	400	1050	3,3	22	30	42,5	1,2	37,5	-	82,5	272,2	11	8,3	MHBA014330*J#	
800	400	1050	3,3	22	30	42,5				see lugs drawing	82,5	272,2	12,5	7,6	MHBA014330*SS
800	400	1050	4	22	33,5	42,5	1,2	37,5	-	82,5	330	12	7,3	MHBA014400*J#	
800	400	1050	4	22	33,5	42,5				see lugs drawing	82,5	330	13,5	6,6	MHBA014400*SS
800	400	1050	4,7	20	40	41,5	1,2	37,5	-	82,5	387,7	14	6,6	MHBA014470*J#	
800	400	1050	4,7	20	40	41,5	1,2	37,5	10,2	82,5	387,7	15,5	6	MHBA014470*JSD	
800	400	1050	5	28	37	42,5	1,2	37,5	-	82,5	412,5	14	6,5	MHBA014500*J#	
800	400	1050	5	28	37	42,5	1,2	37,5	10,2	82,5	412,5	15,5	5,9	MHBA014500*JSD	
800	400	1050	5	28	37	42,5				see lugs drawing	82,5	412,5	16,5	5,8	MHBA014500*SS
800	400	1050	6,3	24	44	41,5	1,2	37,5	-	82,5	519,7	14	5,6	MHBA014630*J#	
800	400	1050	6,3	24	44	41,5	1,2	37,5	10,2	82,5	519,7	17,5	5,1	MHBA014630*JSD	
800	400	1050	8	30	45	42,5	1,2	37,5	-	82,5	660	14	4,7	MHBA014800*J#	
800	400	1050	8	30	45	42,5	1,2	37,5	20,3	82,5	660	20	4,1	MHBA014800*JSD	
800	400	1050	8	30	45	42,5				see lugs drawing	82,5	660	22	4	MHBA014800*SS
800	400	1050	10	30	45	57,5	1,2	52,5	-	55	550	14	5,9	MHBA015100*R#	
800	400	1050	10	30	45	57,5	1,2	52,5	10,2	55	550	19	5,3	MHBA015100*RSD	
800	400	1050	10	30	45	57,5				see lugs drawing	55	550	20,5	5,2	MHBA015100*SS
800	400	1050	12,5	35	50	57,5	1,2	52,5	-	55	687,5	14	5,4	MHBA015125*R#	
800	400	1050	12,5	35	50	57,5	1,2	52,5	20,3	55	687,5	20,5	4,8	MHBA015125*RSD	
800	400	1050	12,5	35	50	57,5				see lugs drawing	55	687,5	22	4,7	MHBA015150*SS
800	400	1050	15	35	50	57,5	1,2	52,5	-	55	825	14	5	MHBA015150*R#	
800	400	1050	15	35	50	57,5	1,2	52,5	20,3	55	825	22	4,4	MHBA015150*RSD	
800	400	1050	15	35	50	57,5				see lugs drawing	55	825	24	4,3	MHBA015150*SS
800	400	1050	20	38	57,5	57,5	1,2	52,5	20,3	55	1100	24	3,8	MHBA015200*RSD	
800	400	1050	20	38	57,5	57,5	1,2	52,5	10,2	55	1100	25	3,7	MHBA015200*RST	
800	400	1050	20	38	57,5	57,5				see lugs drawing	55	1100	26	3,7	MHBA015200*SS

(1) Change the * symbol with the needed Cap. tol. code: J=±5%, K=±10%, the # symbol with S for 5mm, L for 25 mm lead length and §§ symbols with needed lugs style - (2) Max. at 100kHz, +70°C for case operating T= +85°C (at T amb. >+70°C and T case>+85°C voltage and Irms de-rating must be observed), C tol. ≤±10% (for wider C tolerance, ESR variation must be taken in consideration) - (3) Typical values at 100kHz (for operating frequencies far from the reference, ESR variation and related power dissipation variation must be taken in consideration) - (4) Not suitable for across the line application