

## ST Series 5 mm 105°C

### Features

- ◆ 5.0+1 mm max height
- ◆ Endurance 105°C, 1000 hrs assured
- ◆ RoHS Compliant

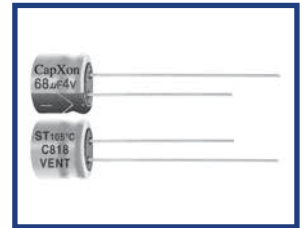

### Specifications

Item	Performance Characteristics							
Operating Temperature Range	-40 to +105°C							
Rated Voltage Range	4 to 50 VDC							
Capacitance Range	0.1 to 100 µF							
Capacitance Tolerance	±20% (120Hz, +20°C)							
Leakage Current(+20°C, max)	1 ≤ 0.01 CV or 3 (µA) After 2 minutes, whichever is greater measured with rated working voltage applied.							
Dissipation Factor (tan δ · at 20°C · 120Hz)	Working Voltage (VDC)	4	6.3	10	16	25	35	50
	D.F. (%)max	35	24	20	16	14	12	10
Low Temperature Characteristics (at 120Hz)	Impedance ratio max							
	Working Voltage (VDC)	4	6.3	10	16	25	35	50
	Z-25°C / Z+20°C	6	3	3	2	2	2	2
Endurance	Test conditions							
	Duration time	:1000 Hrs						
	Ambient temperature	:+105°C						
	Applied voltage	:Rated DC working voltage						
Shelf Life	After test requirement at +20°C							
	Capacitance change	:≤ ±20% of the initial measured value (4V : ≤ ±30%)						
	Dissipation factor	:≤ 200% of the initial specified value						
	Leakage current	:≤ The initial specified value						
Shelf Life	Test conditions							
	Duration time	:1000 Hrs						
	Ambient temperature	:+105°C						
	Applied voltage	:None						
After test requirement at +20°C : Same limits as Endurance. Pre-treatment for measurements shall be conducted after application of DC working voltage for 30 minutes.								

### Multiplier for Ripple Current vs. Frequency

CAP(µ F)\Frequency(Hz)	50(60)	120	1K	≥10K
0.1~47	0.8	1	1.30	1.50
100~220	0.8	1	1.15	1.20

### Diagram of Dimensions:(unit:mm)

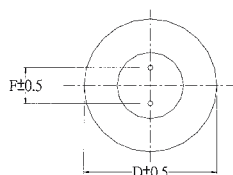
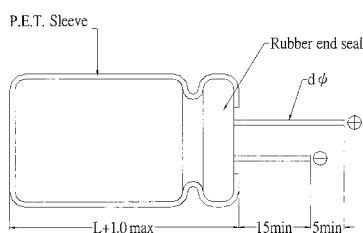

D φ	4	5	6.3	8
F	1.5±0.5	2.0±0.5	2.5±0.5	3.5±0.5
d φ	0.45			

## Case Size

WV Cap( $\mu$ F)	4		6.3		10		16		25		35		50	
	Size	Ripple	Size	Ripple	Size	Ripple	Size	Ripple	Size	Ripple	Size	Ripple	Size	Ripple
0.1													4x5	1.5
0.15													4x5	2.0
0.22													4x5	2.6
0.33													4x5	3.2
0.47													4x5	3.8
0.68													4x5	5
1													4x5	6.2
1.5													4x5	7
2.2											4x5	7.5	4x5	11
3.3													4x5	14
4.7										4x5	8.5	4x5	11	
6.8												4x5	15	5x5
10													4x5	19
					4x5	11							5x5	22
					4x5	15	4x5	18	5x5	23	5x5	25	6.3x5	25
	4x5	10	4x5	12										
15	4x5	13	4x5	15	4x5	18	5x5	23	6.3x5	32	6.3x5	32	8x5	35
22	4x5	22	4x5	22	5x5	27	5x5	30	6.3x5	39	6.3x5	48	8x5	50
33	5x5	30	5x5	30	5x5	35	6.3x5	45	6.3x5	48	8x5	50		
47	5x5	36	5x5	36	6.3x5	48	6.3x5	50	6.3x5	50				
									8x5	55				
68	6.3x5	52	6.3x5	52	6.3x5	53	8x5	55						
100	6.3x5	60	6.3x5	60	8x5	65	8x5	68						
220	6.3x5	80	6.3x5	80	8x5	83								

Ripple Current ( mA, rms ) at 105°C 120Hz